



# Laminar Flow Cabinet

/ Laboratory and Processing Equipment



**LAB1ST** / Laboratory and Processing Equipment

Labfirst Scientific Instruments (Shanghai) Co., Ltd

☎ +86-13524020331 (China)

+1-844-452-2178 (USA)

✉ sales@lab1st.com

🌐 www.lab1st.com

📘 lab1st

📷 lab1st\_extraction



Lab1st laminar flow cabinet provides a safe and contamination free environment for samples, equipments and any particle sensitive materials. It can be used in a multitude of settings like hospital, laboratories, pharmaceutical industry and so on.

## An Ultra-Clean Work Zone

Laminar Flow Cabinet is a work bench which can filter out harmful particles in the air and create a laminar, unidirectional and sterile airflow in the work zone, which acts as an effective solution for samples, equipments and particle sensitive materials that require contamination free environment.

### Product Type

According to the different direction air is blown in the cabinet, laminar flow cabinet can be classified into two types:

**Horizontal Type and Vertical Type.**



Lab1st supplies both types, and we also provide products that meet the ETL certification.

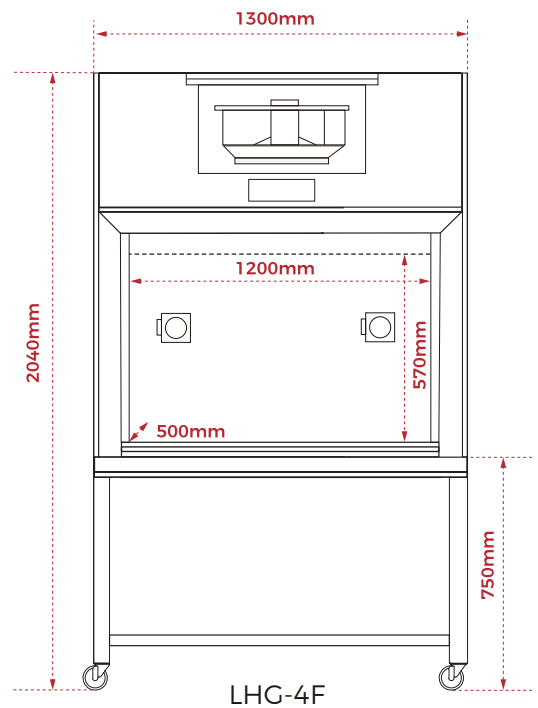



## Features

### Effective sample protection

Every product is equipped with a HEPA filter with **99.995%** efficiency at **0.3µm** which offers a sterile and continuous airflow in the work zone.

### Safety guarantee

Our product is equipped with waterproof socket as well as the audio and visual alarm system to fully ensure safety.

We endeavor to research, develop and produce high quality, user-friendly and cost-effective laminar flow cabinets to our customers.

### Easy to use

The large side glass windows, footmaster casters, memory function, wind speed sensors and **LCD** display can highly facilitate your operation process.

### Low noise level

The noise level is lower than **65dB**.





## Schematic Diagram

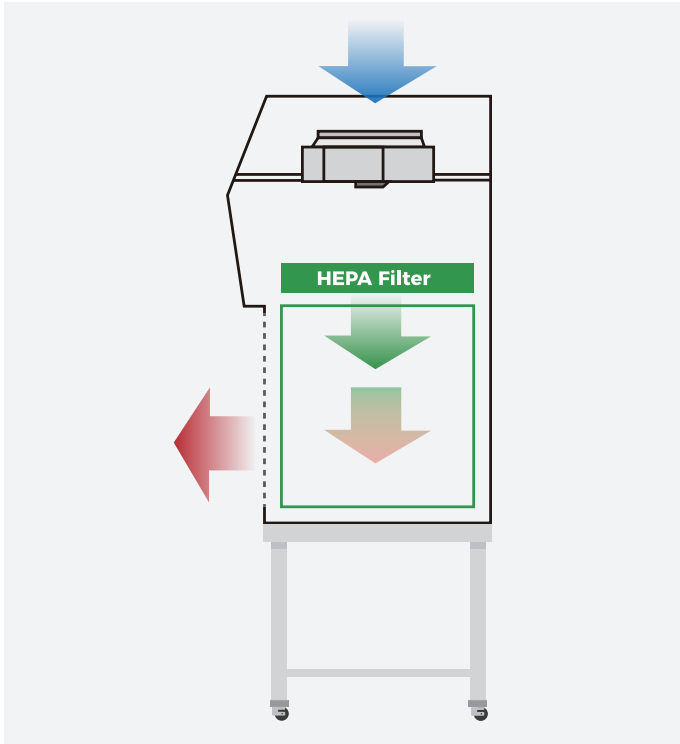

### Vertical type

In a vertical laminar flow cabinet, the filter is at the top of the cabinet and the sterile air vertically passes through the work zone.

#### Vertical Type

- Polluted Air
- HEPA Filtered Air
- Room Air

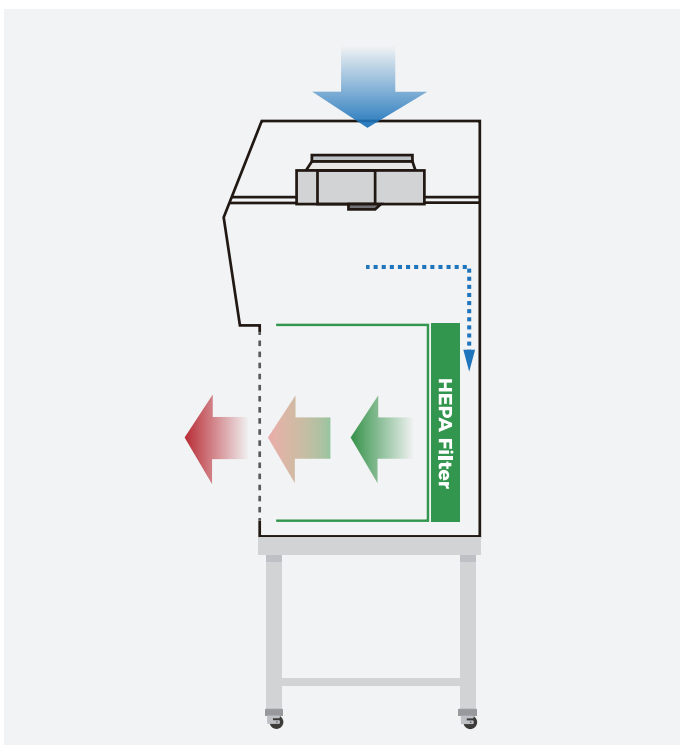

### Horizontal type

In a horizontal laminar flow cabinet, the filter is on the back of the cabinet and the filtered air horizontally passes through the work zone.

#### Vertical Type

- Polluted Air
- HEPA Filtered Air
- Room Air

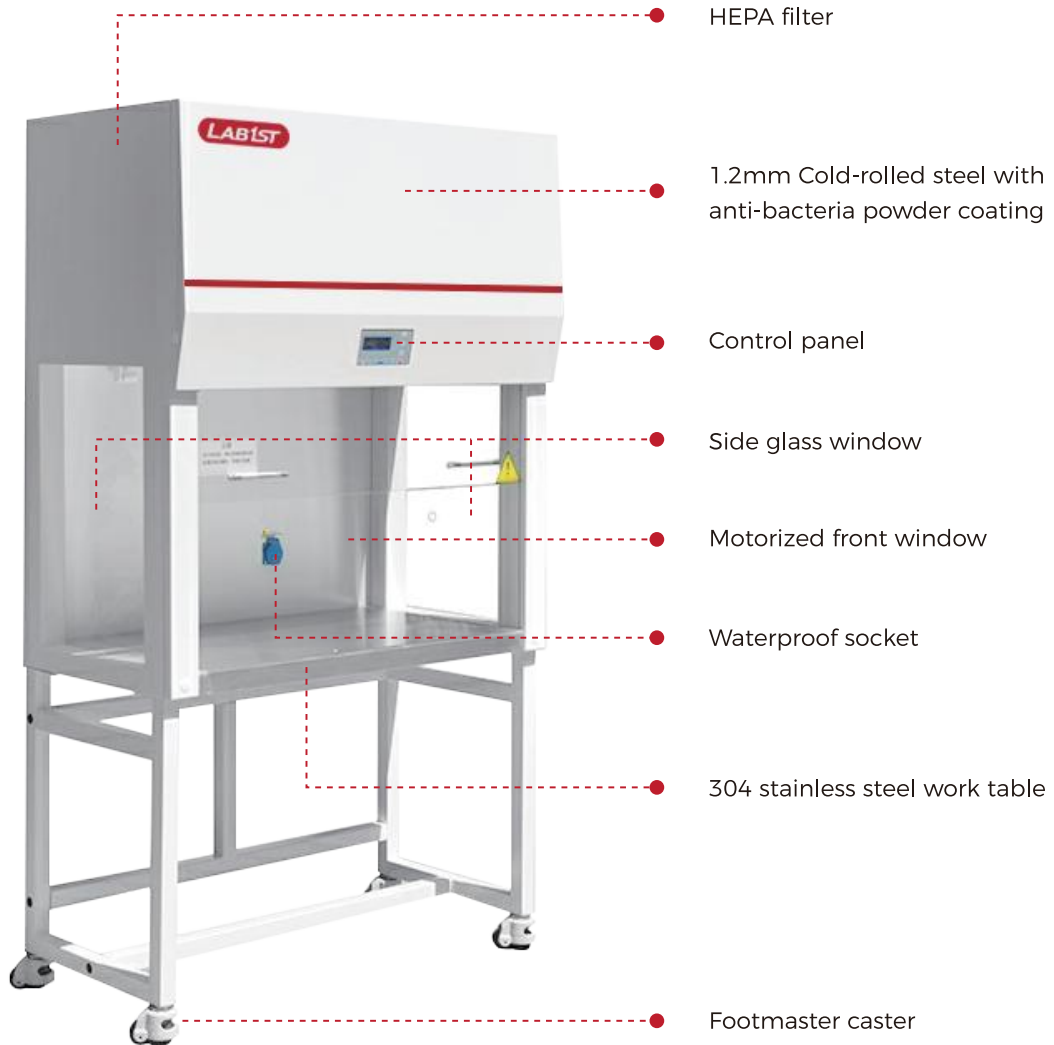

## ETL Certified Horizontal Laminar Flow Cabinet

Model	LHG-2F (ETL)	LHG-3F (ETL)	LHG-4F (ETL)
External Size (W×D×H)	800×810× (1720~ 1980)mm	1100×810× (1720~1980)mm	1300×810× (1720~1980)mm
	31.5"×31.9" (67.7"~77.9")	43.3"×31.9"× (67.7"~77.9")	51.2"×31.9"× (67.7"~77.9")
Internal Size (W×D×H)	700×500×600mm	1000×500×600mm	1200×500×600mm
	27.6"×19.7"×23.6"	39.4"×19.7"×23.6"	47.2"×19.7"×23.6"
Work Surface Height	750~1010mm (29.5"~39.8")		
Max Opening	440mm (17.3")		
Display	LCD Display		
Airflow Velocity	80~99fpm		
Material	Working area: 304 stainless steel.		
	Main Body: 1.0 mm cold-rolled steel with anti-bacteria powder coating.		
	Front Window: 5 mm toughened glass, anti-UV.		
Pre-Filter	Polyester fiber		
HEPA Filter	One, 99.995% efficiency at 0.3μm		
Noise	≤68dB(A)		
Illumination	≥300lx		
Waterproof Sockets	One socket (double type), America standard, Max Power: 500W		
Power Supply	103.5~126.5V, 60Hz, 10A		
Consumption	750W	950W	950W
LED Lamp	10W×1	14W×1	14W×1
Standard Accessory	Manually height adjustable base stand, LED lamp, wind speed sensor, waterproof socket, Stainless Steel I.V. Bar with 10 hooks		
Optional Accessory	UV lamp		
Package Size (W×D×H)	940×1090×1250mm	1240×1090×1250mm	1440×1090×1250mm
	37.0"×42.9"×49.2"	48.8"×42.9"×49.2"	56.7"×42.9"×49.2"
Gross Weight	150Kg	190Kg	225Kg

Model	LHG-5F (ETL)	LHG-6F (ETL)
External Size (W×D×H)	1500×810× (1720~1980)mm	1800×810× (1720~1980)mm
	59.1"×31.9"× (67.7"~77.9")mm	70.9"×31.9"× (67.7"~77.9")
Internal Size (W×D×H)	1400×500×600mm	1700×500×600mm
	55.1"×19.7"×23.6"	66.9"×19.7"×23.6"
Work Surface Height	750~1010mm (29.5"~39.8")	
Max Opening	440mm (17.3")	
Display	LCD Display	
Airflow Velocity	80~99fpm	
Material	Working area: 304 stainless steel.	
	Main Body: 1.0 mm cold-rolled steel with anti-bacteria powder coating.	
	Front Window: 5 mm toughened glass, anti-UV.	
Pre-Filter	Polyester fiber	
HEPA Filter	One, 99.995% efficiency at 0.3µm	
Noise	≤68dB(A)	
Illumination	≥300lx	
Waterproof Sockets	One socket (double type), America standard, Max Power: 500W	
Power Supply	103.5~126.5V, 60Hz, 10A	
Consumption	950W	1150W
LED Lamp	18W×1	22W×1
Standard Accessory	Manually height adjustable base stand, LED lamp, wind speed sensor, waterproof socket, Stainless Steel I.V. Bar with 10 hooks	
Optional Accessory	UV lamp	
Package Size (W×D×H)	1640×1090×1250mm	1940×1090×1250mm
	64.6"×42.9"×49.2"	76.4"×42.9"×49.2"
Gross Weight	265Kg	300Kg

# Horizontal Laminar Flow Cabinet

Model	LHG-4F	LHG-6F
External Size (W×D×H)	1300×820×2040mm	1800×820×2070mm
	51.2"×32.3"×80.3"	70.9"×32.3"×81.5"
Internal Size (W×D×H)	1200×500×570mm	1700×500×570mm
	47.2"×19.7"×22.4"	66.9"×19.7"×22.4"
Work Surface Height	750mm (29.5")	
Display	LCD Display	
Airflow Velocity	Average of 0.3-0.5m/s	
Material	Main Body: cold-rolled steel with anti-bacteria powder coating	
	Work Table: 304 stainless steel	
	Side and front Window: 5mm toughened glass, anti-UV	
Pre-Filter	Polyester fiber, washable	
HEPA Filter	99.995% efficiency at 0.3μm	
Noise	<65dB	
Front Window	Motorized	
Max Opening	430mm(16.9")	
LED Lamp	12W×1	16W×2
UV Lamp	30W×1	30W×1
	Emission of 253.7 nanometers	
Consumption	400W	500W
Waterproof Socket	Two, total load≤500W	
Caster	Universal caster with leveling feet	
Power Supply	AC220V±10%, 50/60HZ; 110V±10%, 60Hz	
Standard Accessory	LED lamp, UV lamp×2, Base stand, Gas Tap, Waterproof socket×2	
	Water tap(only for LHG-6F)	
Optional Accessory	Electric height adjustable base stand	
Gross Weight	254Kg	328Kg
	1450×1060×1650mm	1950×1060×1600mm
Package Size(W×D×H)	57.1"×41.7"×65.0"	76.8"×41.7"×63.0"



# Horizontal Laminar Flow Cabinet

Model	LHG-3FS	LHG-5FS	LHG-6FS
External Size (W×D×H)	1100×808×1690mm	1500×808×1690mm	1800×808×1890mm
	43.3"×31.8"×66.5"	59.1"×31.8"×66.5"	70.9"×31.8"×77.4"
Internal Size (W×D×H)	1000×500×600mm	1400×500×600mm	1700×500×800mm
	39.4"×19.7"×23.6"	55.1"×19.7"×23.6"	66.9"×19.7"×31.5"
Work Surface Height	750mm (29.5")		
Display	LCD Display		
Airflow Velocity	Average of 0.30-0.45m/s		
Material	Main Body: Cold-rolled steel with anti-bacteria powder coating		
	Work Table: 304 stainless steel		
	Side Windows: 8mm toughened glass, anti-UV		
Pre-Filter	Polyester fiber, washable		
HEPA Filter	99.995% efficiency at 0.3μm		
Noise	≤65dB(A)		
LED Lamp	12W×1	16W×1	16W×2
UV Lamp	20W×1	30W×1	20W×2
	Emission of 253.7 nanometers		
Consumption	200W	300W	400W
Waterproof Socket	Two, total load≤500W		
Caster	Universal caster with leveling feet		
Power Supply	AC220V±10%, 50/60HZ; 110V±10%, 60Hz		
Standard Accessory	LED lamp, UV lamp×2, Base stand, Waterproof socket×2, Hook×10		
Optional Accessory	Electric height adjustable base stand		
Gross Weight	175Kg	216Kg	255Kg
	1250×1050×1350mm	1650×1050×1350mm	1950×1050×1550mm
Package Size (W×D×H)	49.2"×41.3"×53.1"	65.0"×41.3"×53.1"	76.8"×41.3"×61.0"

## ETL Certified Vertical Laminar Flow Cabinet

Model	LVG-2FS (ETL)	LVG-3FS (ETL)	LVG-4FS (ETL)
External Size (W×D×H)	800×700× (2090~2340)mm	1100×700× (2090~2340)mm	1300×700× (2090~2340)mm
	31.5"×27.6"× (82.3"~92.1")	43.3"×27.6"× (82.3"~92.1")	51.2"×27.6"× (82.3"~92.1")
Internal Size (W×D×H)	700×575×625mm	1000×575×625mm	1200×575×625mm
	27.6"×22.6"×24.6"	39.4"×22.6"×24.6"	47.2"×22.6"×24.6"
Work Surface Height	750~1010mm (29.5"~39.8")		
Max Opening	480mm (18.9")		
Display	LCD Display		
Airflow Velocity	80~99fpm		
Material	Working area: 304 stainless steel		
	Main Body: 1.2mm Cold-rolled steel with anti-bacteria powder coating.		
	Front Window: Motorized, 5mm toughened glass, anti-UV		
Pre-Filter	Polyester fiber		
HEPA Filter	One, 99.995% efficiency at 0.3µm		
Noise	≤68dB(A)		
Illumination	≥300lx		
Waterproof Sockets	One socket (Double type), America standard. Max.Power: 500W		
Power Supply	110V±10% 60HZ		
Consumption	750W	950W	950W
UV Lamp	18W×1	30W×1	30W×1
LED Lamp	10W×1	14W×1	14W×1
Standard Accessory	Manually height adjustable base stand, LED lamp, UV lamp, wind speed sensor, waterproof socket		
Package Size (W×D×H)	940×970×1560mm	1240×970×1560mm	1440×970×1560mm
	37.0"×38.1"×61.4"	48.8"×38.1"×61.4"	56.7"×38.1"×61.4"
Gross Weight	190Kg	230Kg	265Kg

Model	LVG-5FS (ETL)	LVG-6FS (ETL)
External Size (W×D×H)	1500×700× (2090~2340)mm	1800×700× (2090~2340)mm
	59.1"×27.6"× (82.3"~92.1")	70.9"×27.6"× (82.3"~92.1")
Internal Size (W×D×H)	1400×575×625mm	1700×575×625mm
	55.1"×22.6"×24.6"	66.9"×22.6"×24.6"
Work Surface Height	750~1010mm (29.5"~39.8")	
Max Opening	480mm (18.9")	
Display	LCD Display	
Airflow Velocity	80~99fpm	
Material	Working area: 304stainless Steel	
	Main Body: 1.2mm Cold-rolled steel with anti-bacteria powder coating.	
	Front Window: Motorized, 5mm toughened glass, anti-UV	
Pre-Filter	Polyester fiber	
HEPA Filter	One, 99.995% efficiency at 0.3µm	
Noise	≤68dB(A)	
Illumination	≥300lx	
Waterproof Sockets	One socket (Double type), America standard. Max.Power: 500W	
Power Supply	110V±10% 60HZ	
Consumption	950W	1150W
UV Lamp	40W×1	40W×1
LED Lamp	18W×1	22W×1
Standard Accessory	Manually height adjustable base stand, LED lamp, UV lamp, wind speed sensor, waterproof socket	
Package Size (W×D×H)	1640×970×1560mm	1940×970×1560mm
	64.6"×38.1"×61.4"	76.4"×38.1"×61.4"
Gross Weight	280Kg	320Kg

## Vertical Laminar Flow Cabinet

Model	LVG-4F	LVG-6F
External Size (W×D×H)	1300×750×2040mm	1800×750×2040mm
	51.2"×29.5"×80.3"	70.9"×29.5"×80.3"
Internal Size (W×D×H)	1200×645×610mm	1700×645×610mm
	47.2"×25.4"×24.0"	66.9"×25.4"×24.0"
Work Surface Height	750mm (29.5")	
Display	LCD Display	
Airflow Velocity	Average of 0.3-0.5m/s	
Material	Main Body: Cold-rolled steel with anti-bacteria powder coating	
	Work Table: 304 stainless steel	
	Side and Front Windows: 5mm toughened glass anti-UV	
Pre-Filter	Polyester fiber, washable	
HEPA Filter	99.995% efficiency at 0.3μm	
Noise	<65dB	
Front Window	Motorized	
Max Opening	430mm (16.9")	
LED Lamp	12W×1	16W×1
UV Lamp	30W×1	40W×1
	Emission of 253.7 nanometers	
Consumption	400W	450W
Waterproof Socket	Two, total load≤500W	
Caster	Universal caster with leveling feet	
Power Supply	AC220V±10%, 50/60HZ; 110V±10%, 60Hz	
Standard Accessory	LED lamp, UV lamp×2, Base stand, Gas Tap, Waterproof socket×2	
Optional Accessory	Electric height adjustable base stand	
Gross Weight	228Kg	306Kg
Package Size (W×D×H)	1460×1070×1650mm	1960×970×1600mm
	57.5"×42.1"×65.0"	77.2"×38.2"×63.0"

## Vertical Laminar Flow Cabinet

Model	LVG-2F	LVG-2.5F
External Size (W×D×H)	680×410×1160mm	802×650×1550mm
	26.8"×16.1"×45.7"	31.6"×25.6"×61.0"
Internal Size (W×D×H)	630×375×615mm	800×530×540mm
	24.8"×14.8"×24.2"	31.5"×20.9"×21.3"
Work Surface Height	/	660mm (26.0")
Display	LED Display	
Airflow Velocity	Average of 0.3-0.5m/s, air speed adjustable	
Material	Main Body: Cold-rolled steel with anti-bacteria power coating	
	Work Table: 304 stainless steel (except model LVG-2F)	
Pre-Filter	Polyester fiber, washable	
HEPA Filter	99.995% efficiency at 0.3 μm	
Noise	<65dB	
Front Window	/	Manual
	/	5mm toughened glass, anti-UV
Max Opening	/	490mm (19.3")
Illuminating Lamp	Fluorescent lamp	LED lamp
	8W×1	8W×1
UV Lamp	15W×1	20W×1
	Emission of 253.7 nanometers	
Consumption	160W	350W
Standard Accessory	Fluorescent lamp	LED lamp
	UV lamp×2	UV lamp×2
	Water & gas tap	Base stand
Optional Accessory	/	Electric height adjustable base stand
Caster	/	Universal wheel with leveling feet
Power Supply	AC220V±10%, 50/60HZ; 110V±10%, 60Hz	
Gross Weight	50Kg	116Kg
Package Size (W×D×H)	840×560×1380mm	960×800×1800mm
	33.1"×22.0"×54.3"	37.8"×31.5"×70.9"

Model	LVG-3F	LVG-4F
External Size (W×D×H)	1060×620×1850mm	1460×620×1850mm
	41.7"×24.4"×72.8"	57.5"×24.4"×72.8"
Internal Size (W×D×H)	935×530×650mm	1335×530×650mm
	36.8"×20.9"×25.6"	52.6"×20.9"×25.6"
Work Surface Height	750mm (29.5")	750mm (29.5")
Display	LCD Display	
Airflow Velocity	Average of 0.3~0.45m/s, air speed adjustable	
Material	Main Body: Cold-rolled steel with anti-bacteria power coating	
	Work Table: 304 stainless steel (except model LVG-2F)	
Pre-Filter	Polyester fiber, washable	
HEPA Filter	99.995% efficiency at 0.3 μm	
Noise	<65dB	
Front Window	Manual	
	5mm toughened glass, anti-UV	
Max Opening	400mm (15.7")	400mm (15.7")
Illuminating Lamp	LED lamp	LED lamp
	12W×1	16W×1
UV Lamp	20W×1	40W×1
	Emission of 253.7 nanometers	
Consumption	150W	250W
Standard Accessory	LED lamp	LED lamp
	UV lamp×2	UV lamp×2
	Base stand	Base stand
Optional Accessory	Electric height adjustable base stand	
Caster	Universal wheel with leveling feet	
Power Supply	AC220V±10%, 50/60HZ; 110V±10%, 60Hz	
Gross Weight	185Kg	231Kg
	1240×900×1350mm	1640×900×1350mm
Package Size (W×D×H)	48.8"×35.4"×53.1"	64.6"×35.4"×53.1"

## Vertical Laminar Flow Cabinet---Double Sides Type

Model	LVS-3F (Dou)	LVS-4F (Dou)
External Size (W×D×H)	1040×660×1770mm	1440×660×1770mm
	40.9"×26.0"×69.7"	56.7"×26.0"×69.7"
Internal Size (W×D×H)	940×560×545mm	1340×560×545mm
	37.0"×22.0"×21.5"	52.8"×22.0"×21.5"
Work Surface Height	750mm (29.5")	
Display	LED Display	
Airflow Velocity	Average of 0.3-0.5m/s	
Material	Main Body: Cold-rolled steel with anti-bacteria powder coating	
	Work Table: 304 stainless steel	
Pre-Filter	Polyester fiber, washable	
HEPA Filter	99.995% efficiency at 0.3μm	
Noise	<65dB	
Front Window	Manual, 5mm toughened glass, anti-UV	
Max Opening	310mm (12.2")	
UV Lamp	20W×1	30W×1
	Emission of 253.7 nanometers	
LED Lamp	12W×1	16W×1
Consumption	350W	600W
Caster	Universal caster with leveling feet	
Power Supply	AC220V±10%, 50/60HZ; 110V±10%, 60Hz	
Standard Accessory	LED lamp, UV lamp×2, Base stand	
Optional Accessory	Electric height adjustable base stand	
Gross Weight	150Kg	186Kg
Package Size (W×D×H)	1190×890×1340mm	1590×890×1340mm
	46.9"×35.0"×52.8"	62.6"×35.0"×52.8"